

THIS DRAWING IS UNPUBLISHED. RELEASED FOR PUBLICATION. ALL RIGHTS RESERVED.  
 BY TYCO ELECTRONICS CORPORATION.

LOC	DIST	REVISIONS			
P	U/R	DESCRIPTION	DATE	DNW	APVD
BD	37	M	063B-0397-03	12MAY03	TK GS

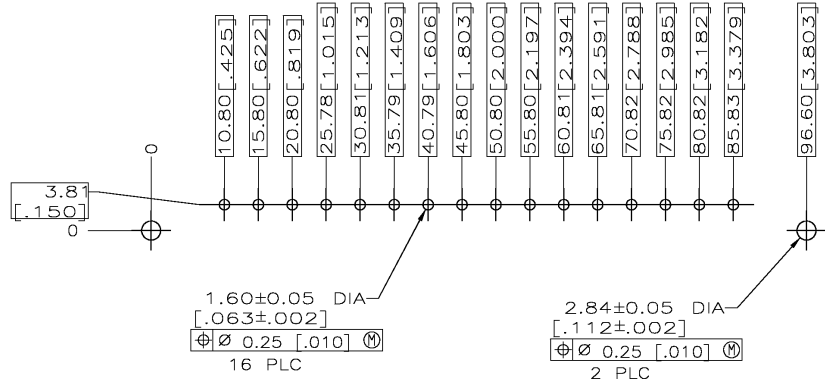

RECOMMENDED PC BOARD LAYOUT

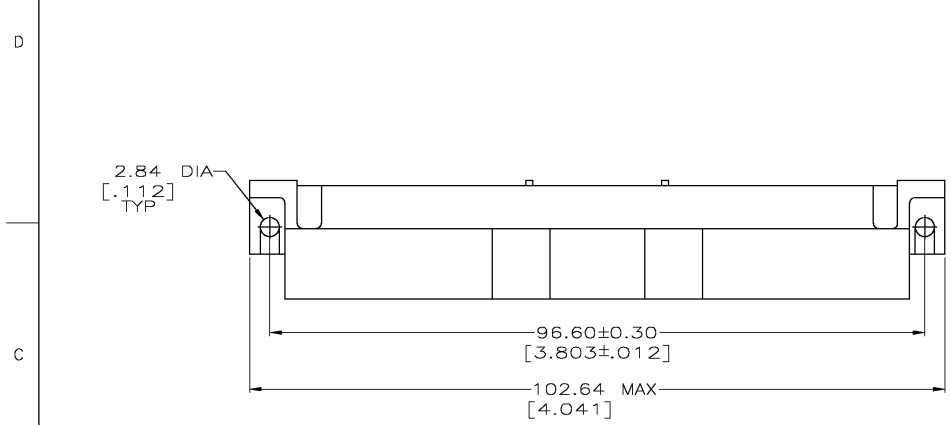
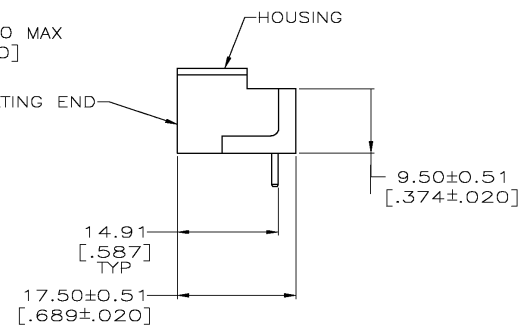
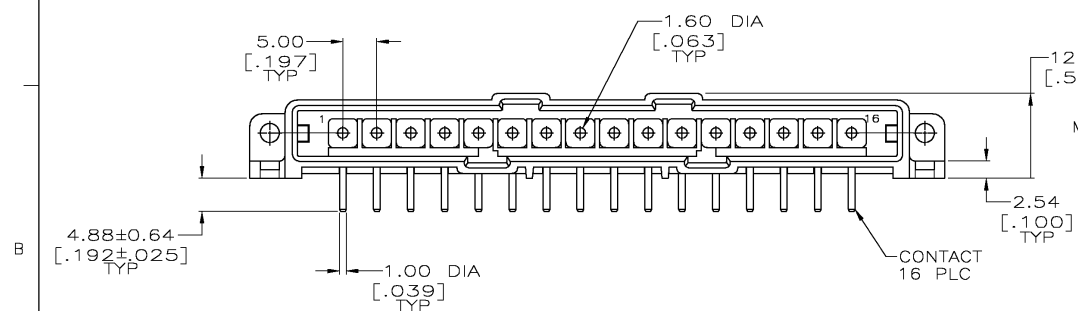

- △ NYLON, RED, VYDYNE M-345 FR.
- △ BRASS PER ASTM B36.
- △ 3.81µm [.000150] MIN TIN-LEAD OVER 2.54µm [.000100] MIN COPPER OR 1.27µm [.000050] MIN NICKEL.
- △ 0.76µm [.000030] MIN GOLD FOR A LENGTH OF 5.08 [.200] MIN FROM MATING END, 3.81µm [.000150] MIN TIN-LEAD FOR A LENGTH OF 13.08 [.515] MIN FROM OPPOSITE END, BOTH OVER 1.27µm [.000050] MIN NICKEL.
- △ 0.76µm [.000030] MIN GOLD FOR A LENGTH OF 5.08 [.200] MIN FROM MATING END, 3.81µm [.000150] MIN TIN FOR A LENGTH OF 13.08 [.515] MIN FROM OPPOSITE END, BOTH OVER 1.27µm [.000050] MIN NICKEL.
- △ .000150 MIN LEAD FREE TIN OVER .000100 MIN COPPER, OR .000050 MIN NICKEL.

OBSOLETE	6	207544-8
	5	207544-7
	-	207544-6
	4	207544-3
	3	207544-1
	FINISH	PART NO

THIS DRAWING IS A CONTROLLED DOCUMENT.		DNW	L SIPE	07/01/92	<b>Tyco Electronics</b> Tyco Electronics Corporation Harrisburg, Pa
DIMENSIONS: INCHES		GRK	R STONE	7-8-92	
TOLERANCES UNLESS OTHERWISE SPECIFIED:		APVD	A TRAVIS	7-8-92	PIN HEADER ASSEMBLY, 16 POSN, IN-LINE, RIGHT ANGLE, SMALL METRIC CONNECTOR, METRIMATE
0 PLC ± -		PRODUCT SPEC		NAME	
1 PLC ± -		APPLICATION SPEC		SIZE	AGE CODE
2 PLC ± 0.25 [.010]		RESTRICTED TO		DRAWING NO	
3 PLC ± -		MATERIAL		WEIGHT	
4 PLC ± -		FINISH		A2 00779 ©-207544	
ANGLES ± -		HOUSING: 1		CUSTOMER DRAWING	
CONTACTS: SEE TBL		SCALE		2:1	
		SHEET		1 OF 1	
		REV		M	

207544

A